

Opulent villa in Can Rimbau with bespoke expansion possibilities



Price: 5.850.000 €

GENERAL INFORMATION

Property Ref:	CW-D-SD-585	Category:	Villas, Luxury Houses
Location:	Can	Area:	Can Rimbau
N. Bedroom:	5	N. Bathroom:	5
M ² Property:	5000	M ² Inside:	



This property is not for sale until the energy certificate has not been submitted.

DESCRIPTION

This newly built minimalistic villa is located on the highest point of one of the most prestigious urbanizations of the island, in Can Rimbau.

This urbanisation is located just above the village of Jesus, within a short drive you reach Ibiza Town, the port of Marina Botafoch, as well as restaurants, supermarkets and schools.

The impressive villa offers breathtaking views over Ibiza town, the old town, the countryside and the sea from all rooms.

The property emphasizes its modern luxury and architectural elegance on two floors: The upper level is dedicated to an open space living and dining room, kitchen and one bedroom. Due to its wide windows the living space is flooded by daylight and you enjoy from everywhere the beautiful views. From the living room and kitchen you can access the impressive semi-covered terrace. In summertime you can open the whole space to combine indoor and outdoor living.

Currently the villa offers one bedroom on the upper floor and two bedrooms on the ground floor. All pre-installations are prepared to enlarge this villa to a five bedroom villa on 190 m². The upper floor will then be dedicated to the living room with open plan kitchen with 90 m². On the ground floor you will have the master suite with en suite bathroom and four additional bedrooms. From the master suite and two guest rooms you will have access to the spacious pool terrace. The outdoor area boasts a BBQ and chill out area as well as a garden area.

- **Property Details:**

- Bedrooms: Five en-suite bedrooms
- Heating and Cooling: State-of-the-art underfloor system powered by a hydrobox air source heat pump, comprehensive air conditioning, and underfloor heating
- Interior Finishes: High-quality finishes, including Porcelanosa Xstone and natural Limestone flooring
- Kitchen: Contemporary open-plan layout with a natural stone countertop, fully fitted kitchen
- Doors: Sleek, ultra-thin aluminium sliding doors featuring climate-controlled glass

- **Outdoor Features:**

- Pool: Private infinity pool
- Parking: Private parking
- Garden: Securely fenced garden
- Security: 24/7 security
- Internet: Fibre optic internet



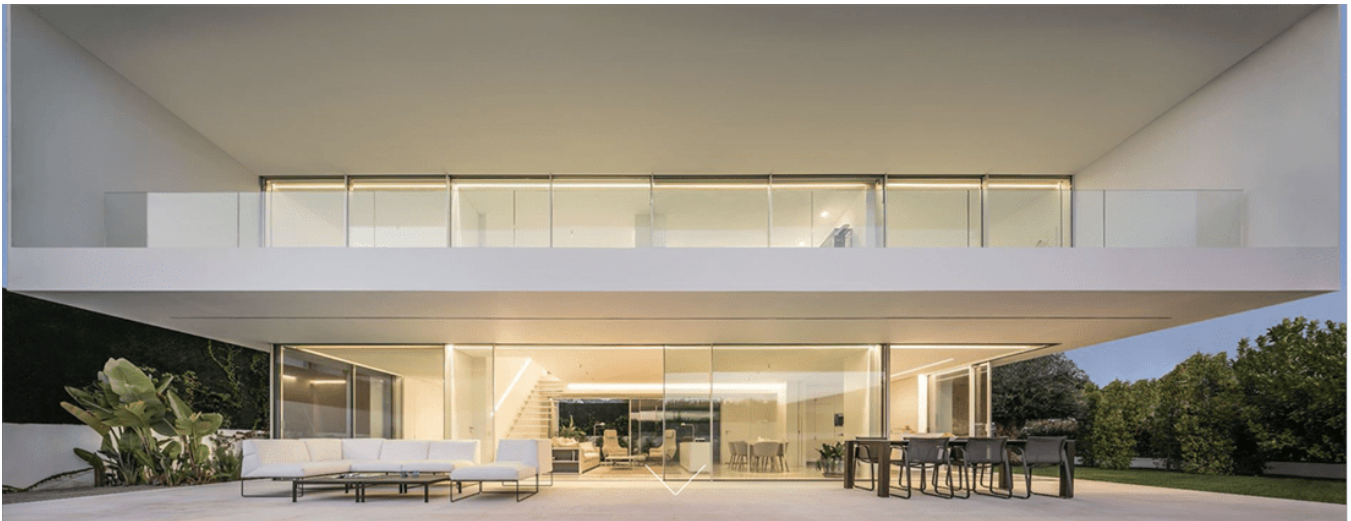















Ctra, Jesus 101, Edif Centro, Planta Baja, Local 5,
07819 Jesus, Ibiza, Spain

Phone: +34 604 190 540 / 871 030 774
E-Mail: info@cw-ibiza.de
Website: www.cw-ibiza.de